

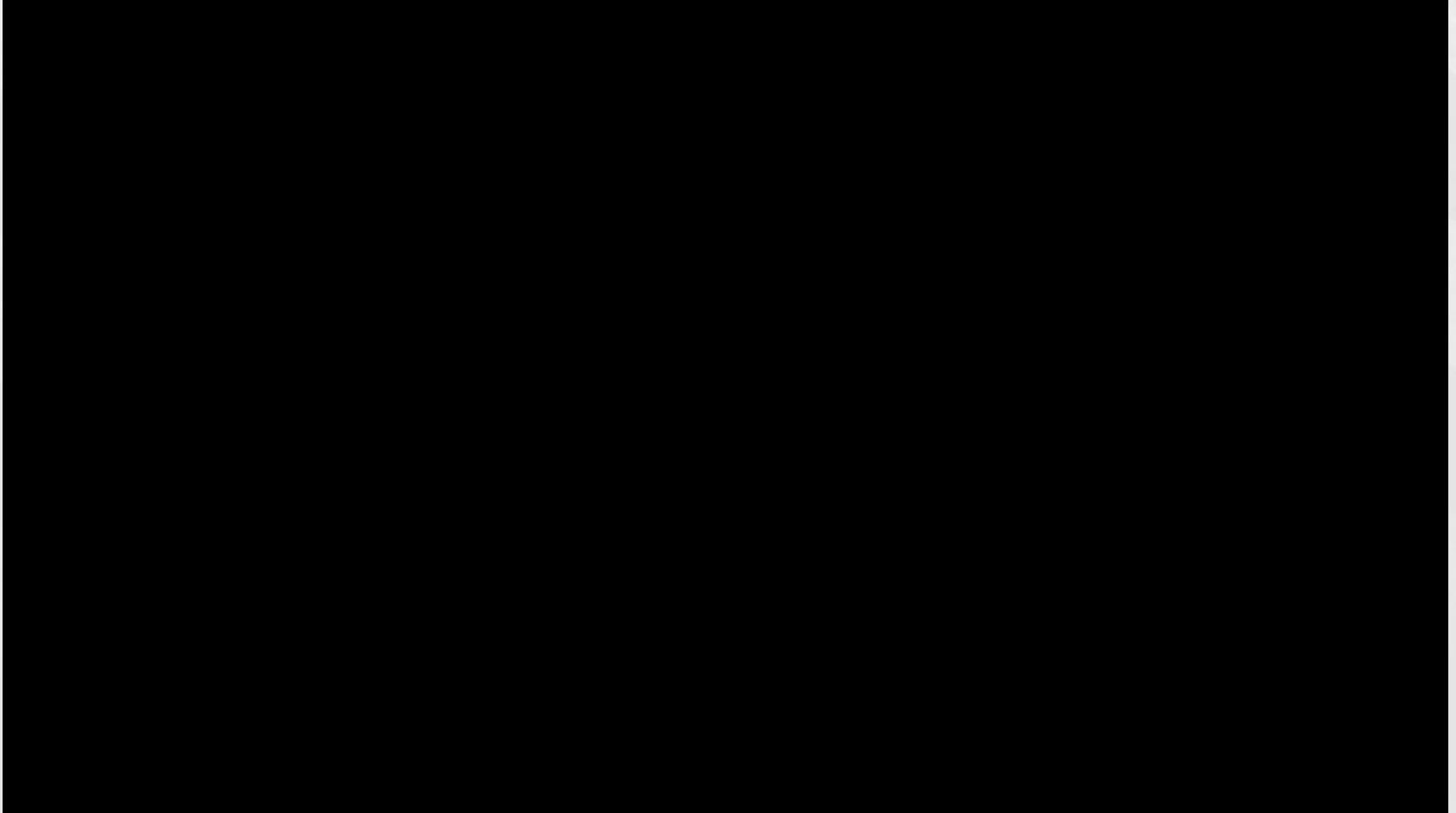

Protecting People On and Off PITs,
Inside & Outside at the Loading Dock

Innovating the Dok-Lok®



Why Innovate Communication?

TO HELP AVOID THE CLASH BETWEEN

Safety + **Productivity**

Innovating the Dok-Lok®

- Pedestrian Protection @ the Loading Dock
- Protecting People **ON** & **OFF** fork trucks inside @ the loading dock
- Protecting people outside **ON THE APPROACH** @ the loading dock
- Keeping People **OFF THE APPROACH** @ the loading dock



New Pedestrian-Vu Advantages

- Big Advantage = Any Movement in Trailer
 - Not just Fork Trucks
 - Any Material Handling Equipment
 - People on Foot in Trailer
- **Blue** Light On Fork Truck
 - **Only** on Fork Trucks
 - Not on Employees or other Material Handling Equipment
 - **Disappears** once in trailer

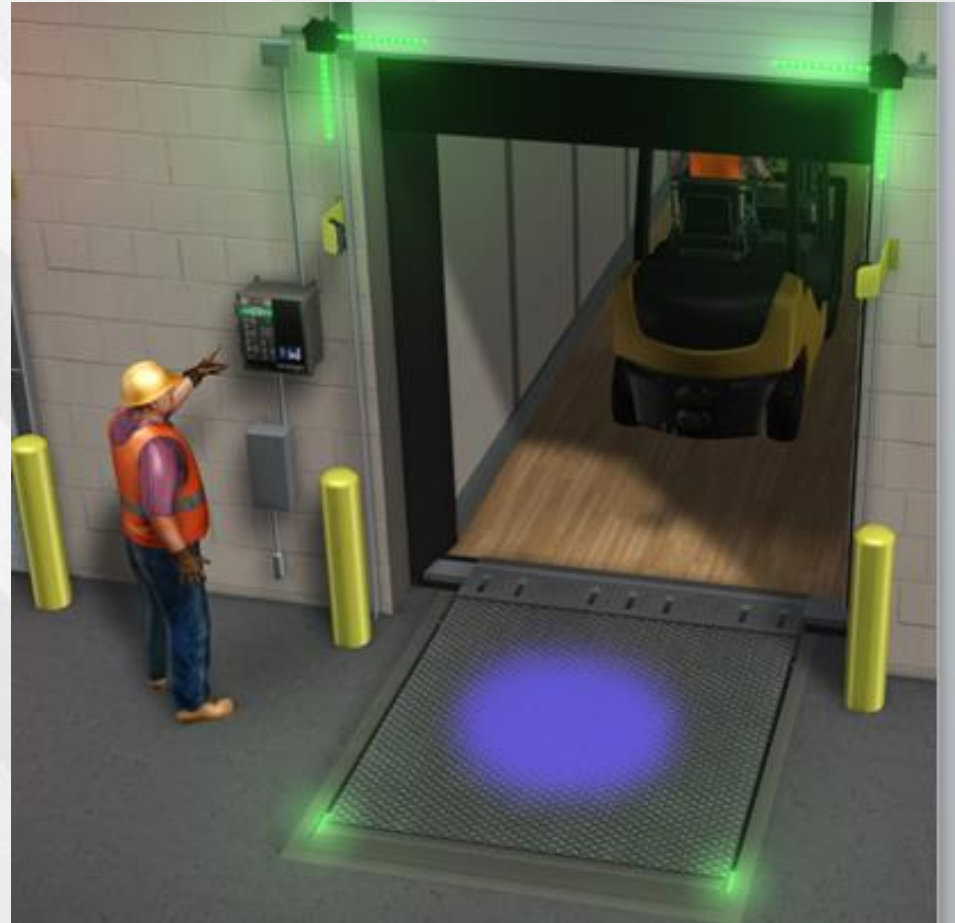

New Pedestrian-Vu

Enhances Existing **Blue** Light Strategy

- PIT 20' into the Trailer

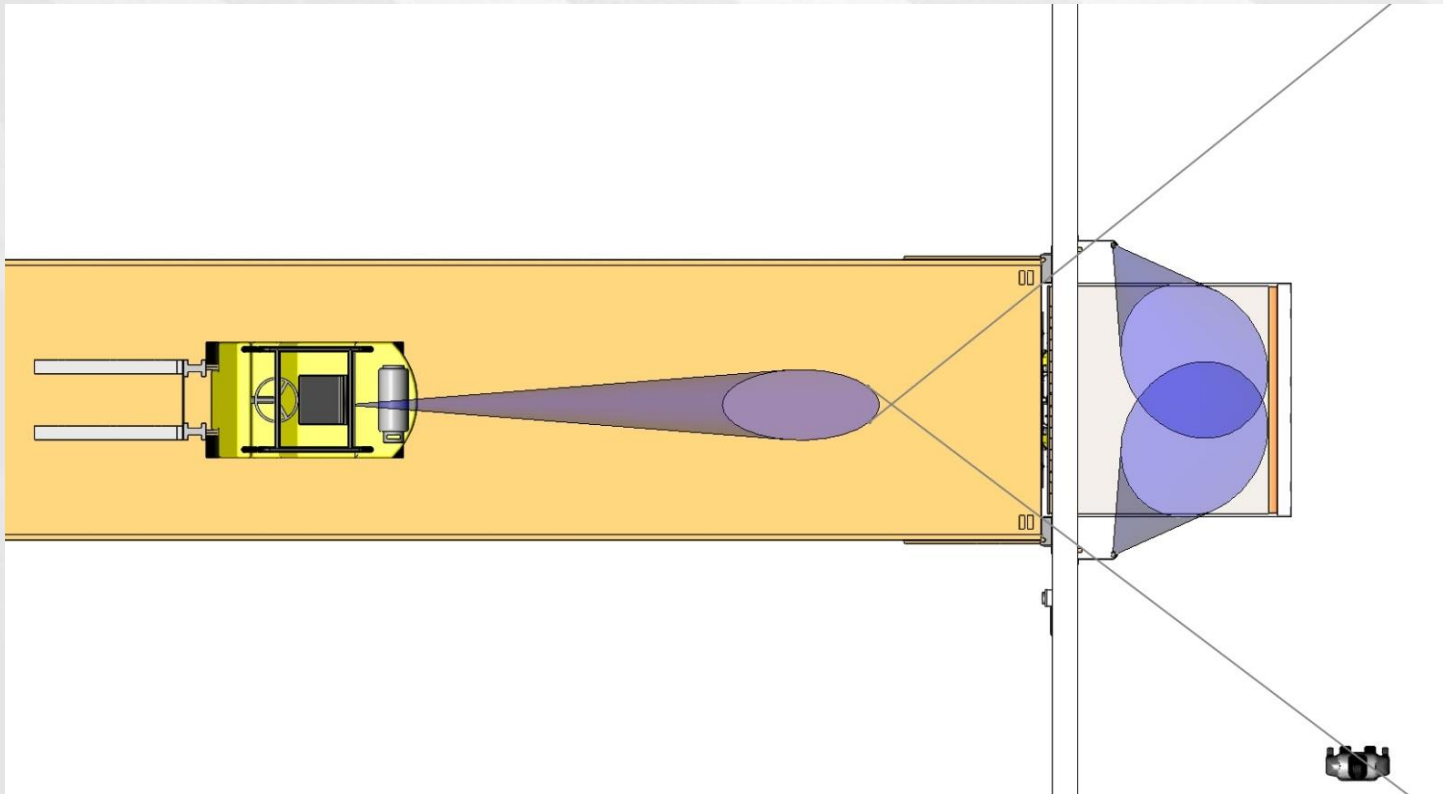

New Pedestrian-Vu

Enhances Existing **Blue** Light Strategy

- PIT 25' into the Trailer

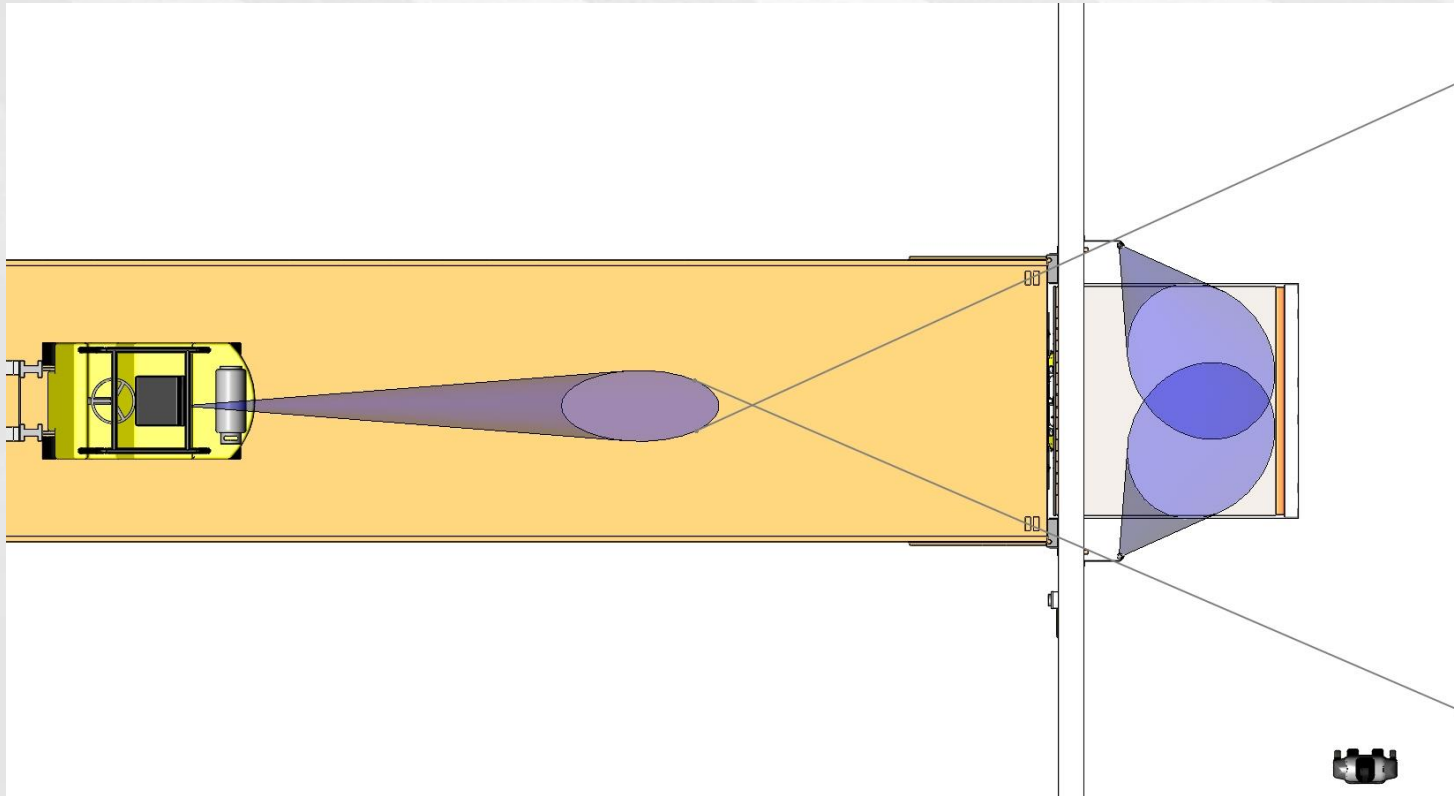

New Pedestrian-Vu Advantages

- Alerts personnel if they enter a trailer on RED light
 - Not just Fork Trucks
 - Any Material Handling Equipment
 - People on Foot in Trailer
- Can **NOT** unlock trailer if motion is detected
 - Any motion

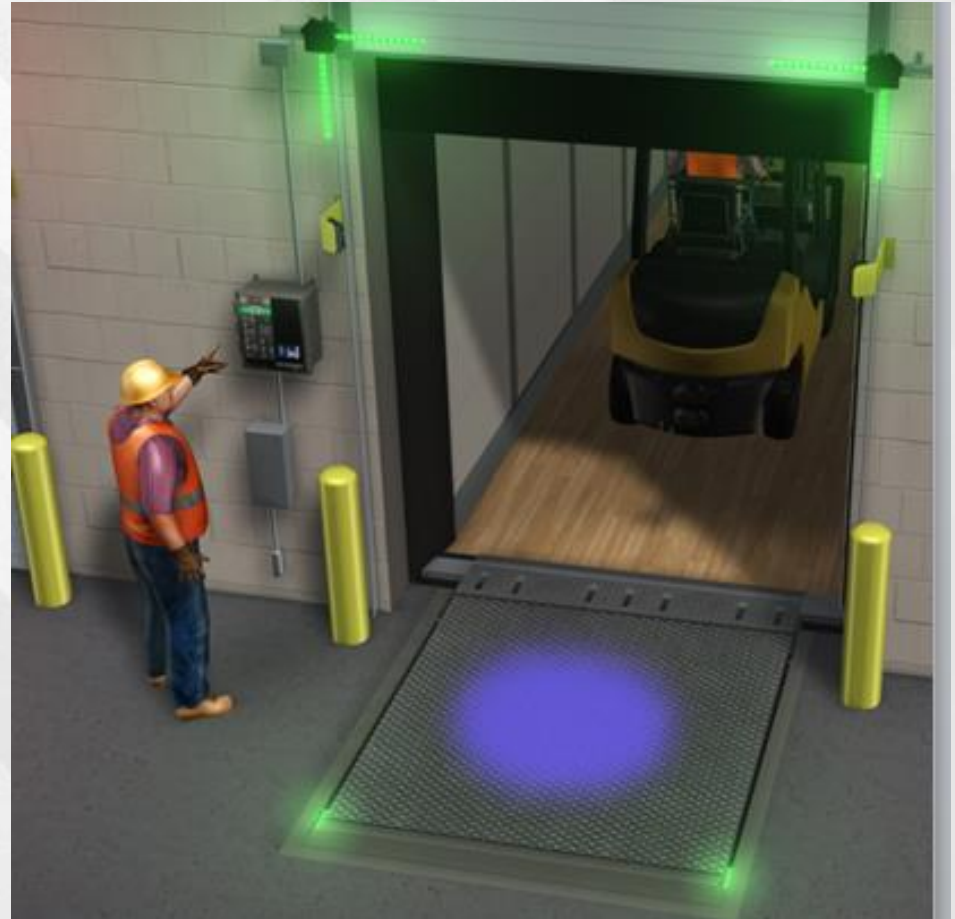

Why Approach-Vu

Feds probe fat Man crushed to death at PTC accident in PTC Alliance Worker Killed

Owen Boss V



July 6, 2016 5:05 P.M. | Mini



COMMENT

0



Recommend

0



Tweet

BRAMPTON, ON - Dream I
for the death of a tempor

By Malcolm Hall

On Mar
at renta
facility a

The truc
dock an
the worl
result of

Worker seriously injured on loading dock in Mentor

By News-Herald staff

POSTED: 11/20/12, 12:01 AM EST

UPDATED: ON 11/20/2012

Lanca
accide

A man is in serious condition after being pinned between a vehicle and a loading dock early Sunday morning.

Reading Eagle

Thursday August 11, 2016 12:01 AM

RITE-HITE
ALWAYS LOOKING AHEAD

Approach-Vu

- A backing semi trailer is silent
- The loading dock approach is busy and dangerous
- Distractions are everywhere
- Approach-Vu brings the **Universal Language of Reverse** to the loading dock for all vehicles



Approach-Vu

- Helps protect Pedestrians on the approach in front of the loading dock
- Senses truck / trailer backing into loading dock
- Alerts Personnel of the presence of a backing vehicle
 - Flashing lights & horn
- Standard with all STR & SHR models
 - Deductible



Approach-Vu How it Works

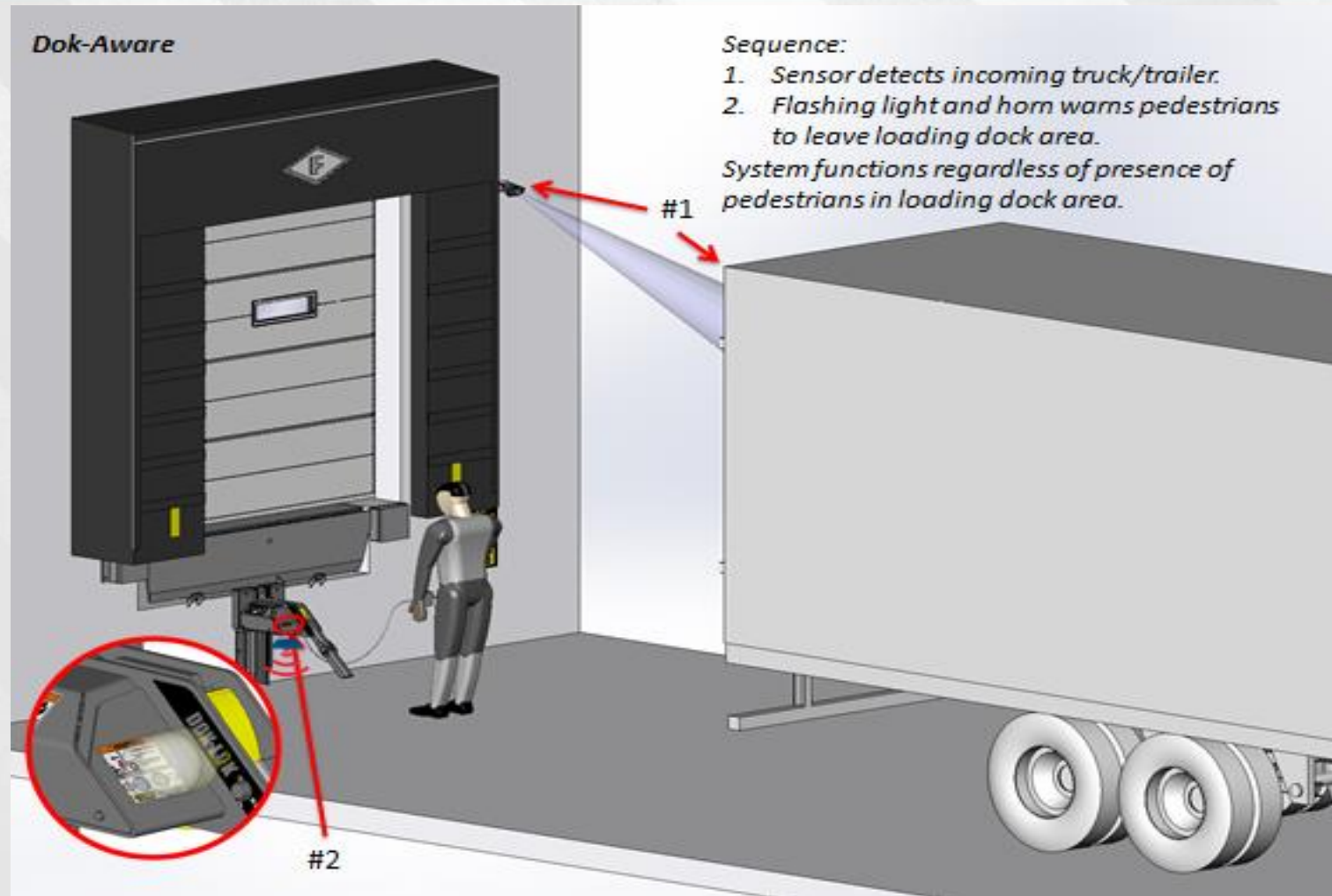

Why Lok-Vu Camera & Monitor System

- Trailer Presence Monitor
- Restraint Verification
- Keeping **“Boots off the ground”** on the approach
- Available on Dok-Commander Controls

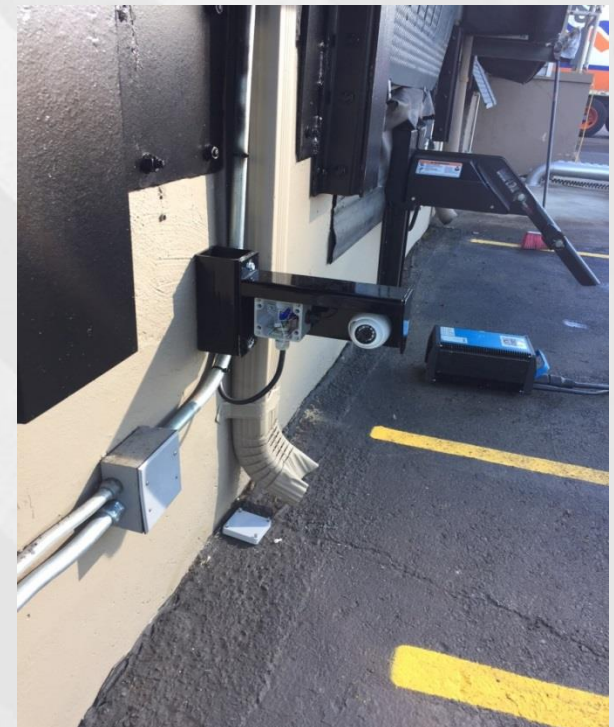

Lok-Vu Features

- Monitor
 - Size: 5.0" diagonal
 - 12VDC input power
 - Color display

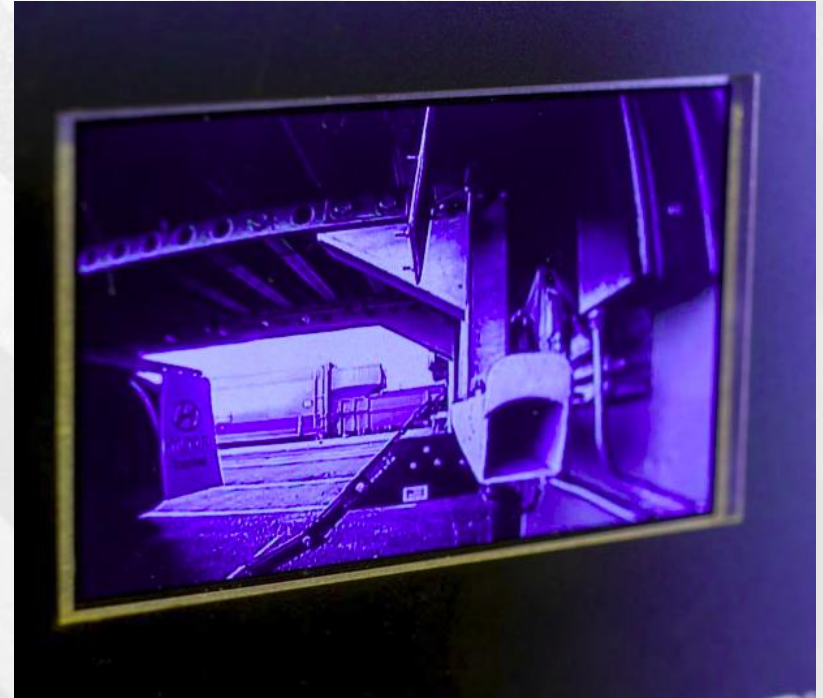

Why Innovate the Dok-Lok

- forklifts annually contribute to more than **100,000 accidents** per year which causes **94,750 injuries***
- OSHA estimates that in the United States alone, there are nearly **100 worker fatalities** and another **20,000 seriously injured** in forklift-related incidents annually
- Almost **80%** of forklift accidents involve a pedestrian, according to OSHA
- According to recent Google alerts, **66 people** have been **crushed** between the loading dock and a trailer

* U.S. Occupational Health and Safety Administration